

DETAILS DE RACCORDEMENT, VOIR FOLIO 2/3
POITIONNEMENT BATTERIES DE DEMARRAGE, VOIR F3/3
(FOR CONNECTIONG DETAILS, SEE SHEET 2/3
ARRANGEMENT START BATTERY, SEE SHEET 3/3)

VERSION 6 TURBOCHARGERS

Ce plan vous est remis à titre indicatif et peut être révisé sans préavis.
This drawing is for informational purposes only and maybe changed whitout notice.

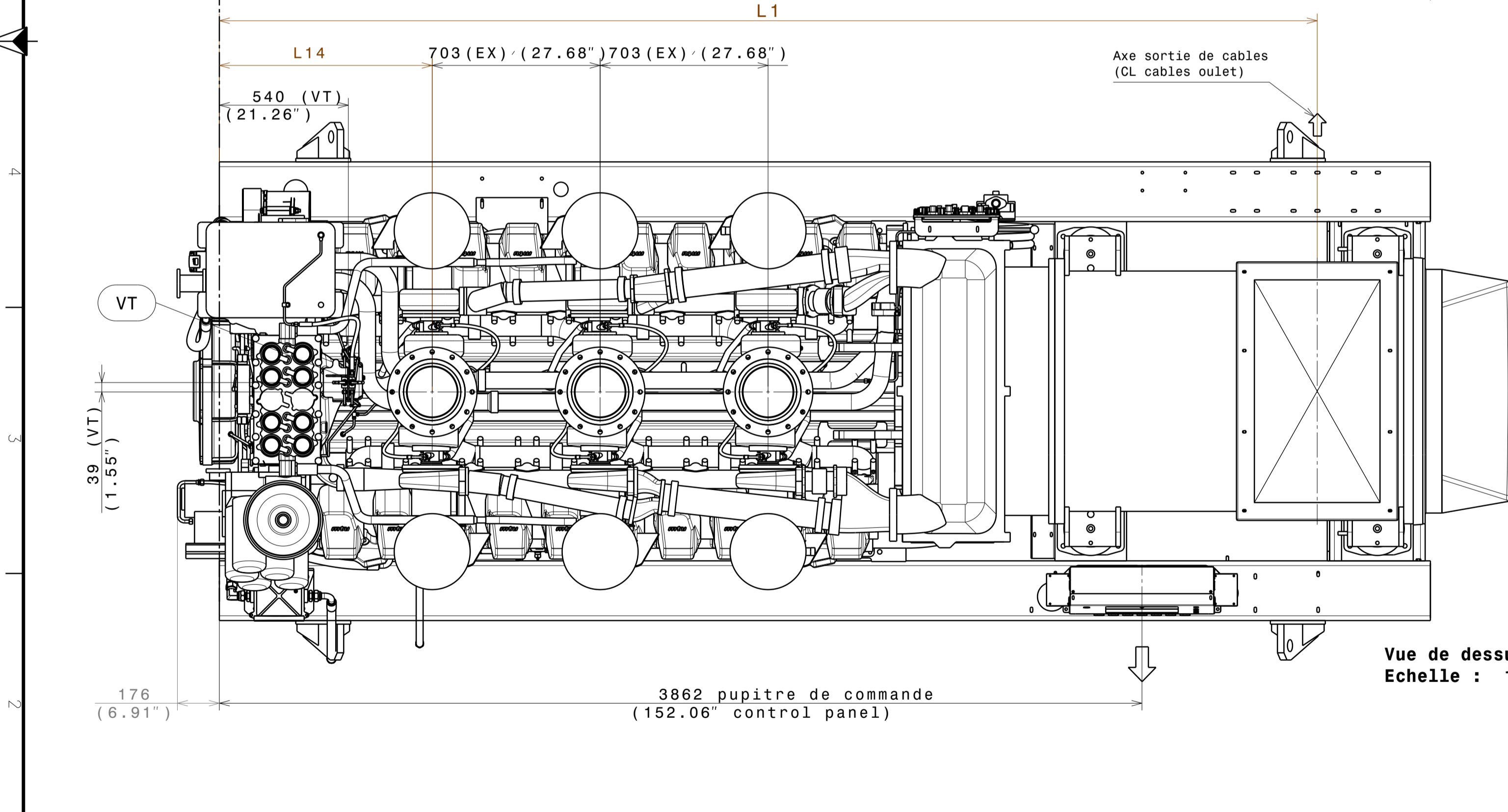

| Moteur Engine | Alternateur Generator | Masse (kg) Weight (lbs) | | L1 (mm/inch) | L2 (mm/inch) | L3 C.D.G. / C.O.G. (mm/inch) | | L4 (mm/inch) | L5 (mm/inch) | L6 (mm/inch) | L7 (mm/inch) | L8 (mm/inch) | L9 (mm/inch) | L10 (mm/inch) | L11 (mm/inch) | L12 (mm/inch) | L13 (mm/inch) | L14 (mm/inch) |
|-------------------|--------------------------|----------------------------|-------------|--------------|--------------|---------------------------------|-------------|-----------------|-----------------|-----------------|-----------------|-----------------|-----------------|------------------|------------------|------------------|------------------|------------------|
| | | A vide/Dry | OdM/Wet | | | A vide/Dry | OdM/Wet | | | | | | | | | | | |
| 20V4000 G23 | LSA 51.2 VL95 | 16009/35295 | 16610/36619 | 4508/177.50 | 222/8.74 | 2355/92.73 | 2323/91.46 | 1200/47.24 | 1440/56.69 | 1870/73.62 | 1817/71.54 | 2278/89.69 | 695/27.36 | 795/31.32 | 911/35.87 | 1143/45.00 | 1196/47.09 | 857/33.74 |
| 20V4000 G43 | LSA 53.1 M70 | 17183/37882 | 17794/39229 | 4574/180.01 | 311/12.25 | 2510/98.83 | 2477/97.50 | 1670/65.75 | 1920/75.59 | 2250/88.58 | 1917/75.45 | 2378/93.61 | 795/31.32 | 895/35.25 | 1011/39.78 | 1243/48.94 | 1296/51.02 | 891/35.08 |
| 20V4000 G23/63/83 | LSA 53.1 M80 | 17343/38235 | 17954/39582 | 4574/180.01 | 311/12.25 | 2537/99.89 | 2503/98.53 | 1670/65.75 | 1920/75.59 | 2250/88.58 | 1917/75.45 | 2378/93.61 | 795/31.32 | 895/35.25 | 1011/39.78 | 1243/48.94 | 1296/51.02 | 891/35.08 |
| 20V4000 G63L | LSA 54 M75 | 18353/40461 | 18964/41808 | 4532/178.43 | 361/14.21 | 2622/103.24 | 2587/101.85 | 1670/65.75 | 1920/75.59 | 2250/88.58 | 1917/75.45 | 2378/93.61 | 795/31.32 | 895/35.25 | 1011/39.78 | 1243/48.94 | 1296/51.02 | 891/35.08 |
| 20V4000 G83L | LSA 54 M9 | 18990/41866 | 19601/43213 | 4532/178.43 | 361/14.21 | 2727/107.35 | 2689/105.88 | 1670/65.75 | 1920/75.59 | 2250/88.58 | 1917/75.45 | 2378/93.61 | 795/31.32 | 895/35.25 | 1011/39.78 | 1243/48.94 | 1296/51.02 | 891/35.08 |

| Rev | Désignation de la modification (Description of change) | Statut (Status) | Date (Drawn by) | Visa (Checked by) | Date (Checked by) | Visa |
|-----|---|--------------------|--------------------|----------------------|----------------------|--------------|
| F | MISE A JOUR COTE L1 | | 27/10/14 | | | BERNARD R |
| E | AJOUT ALTERNATEUR LSA 512 VL95 | | 21/08/14 | | | NICOT M |
| D | ALESAGE CONTRE BRIDE ECHAPPEMENT D1a246 DEVIENT D1a276 | | 02/04/14 | | | KERDRADON C. |
| C | Mise à jour générale | | 30/04/13 | | | G. ARCH |
| B | Modification tableau: Evolution type alternateur | | 28/09/11 | | | G. ARCH |
| A | Création du document (First issue) | | 05/04/11 | | | G. ARCH |

| | | | |
|--------------------------|--|-----------------|------|
| Matière (Material) | - | Format (Size) | A1 |
| Revêtement (Coating) | - | Echelle (Scale) | 1/15 |
| Tolérance (Tolerance) | ISO 2768-mK | Folio (Sheet) | 1/3 |
| Désignation : (Title) | GROUPE ELECTROGENE / GENERATING SET (MOTEUR / ENGINE MTU 20V4000-G03) | Masse (Weight) | Kg |
| SDMO | 3-00-01-4478-01 | Rev.: F | |

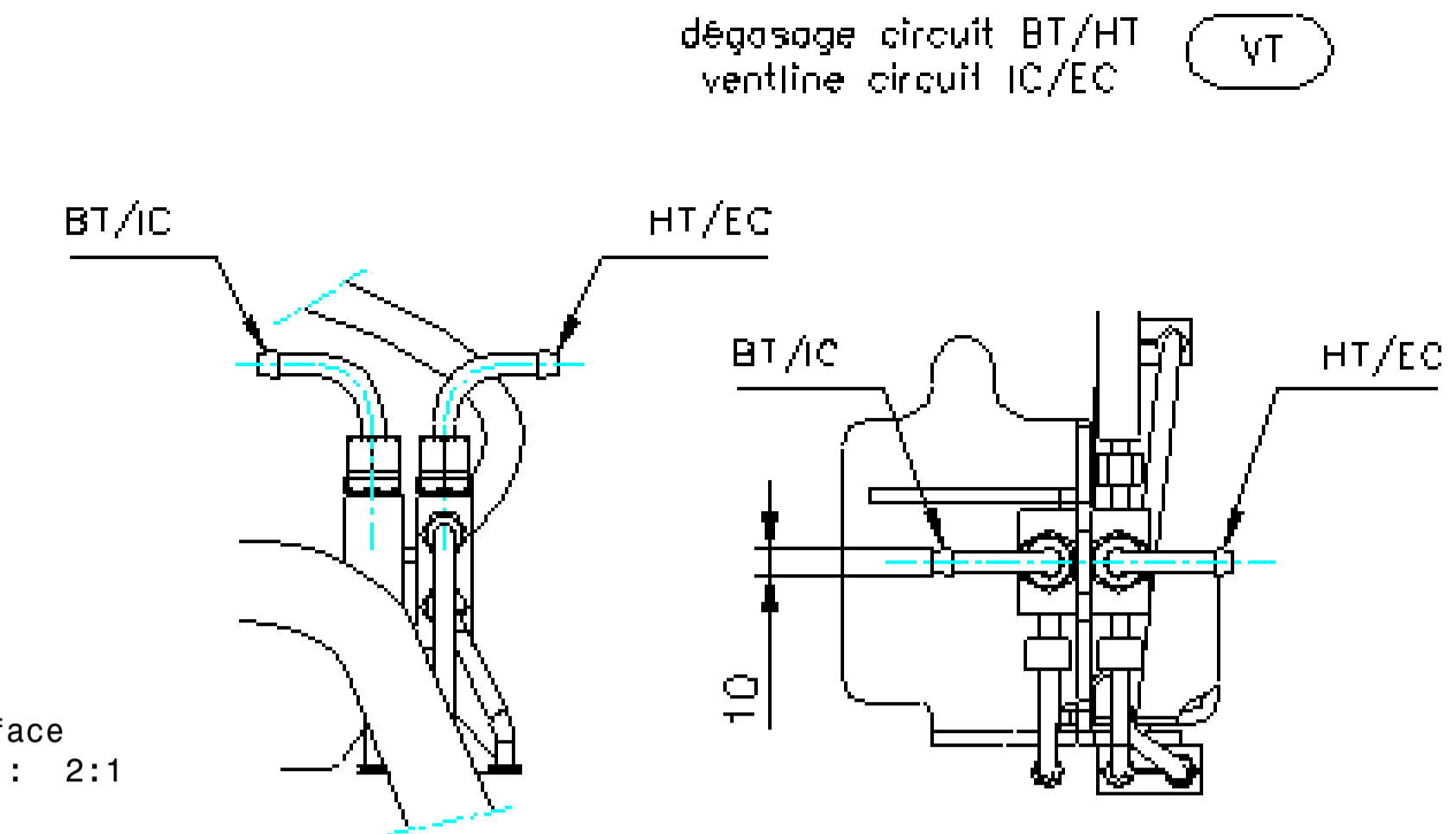
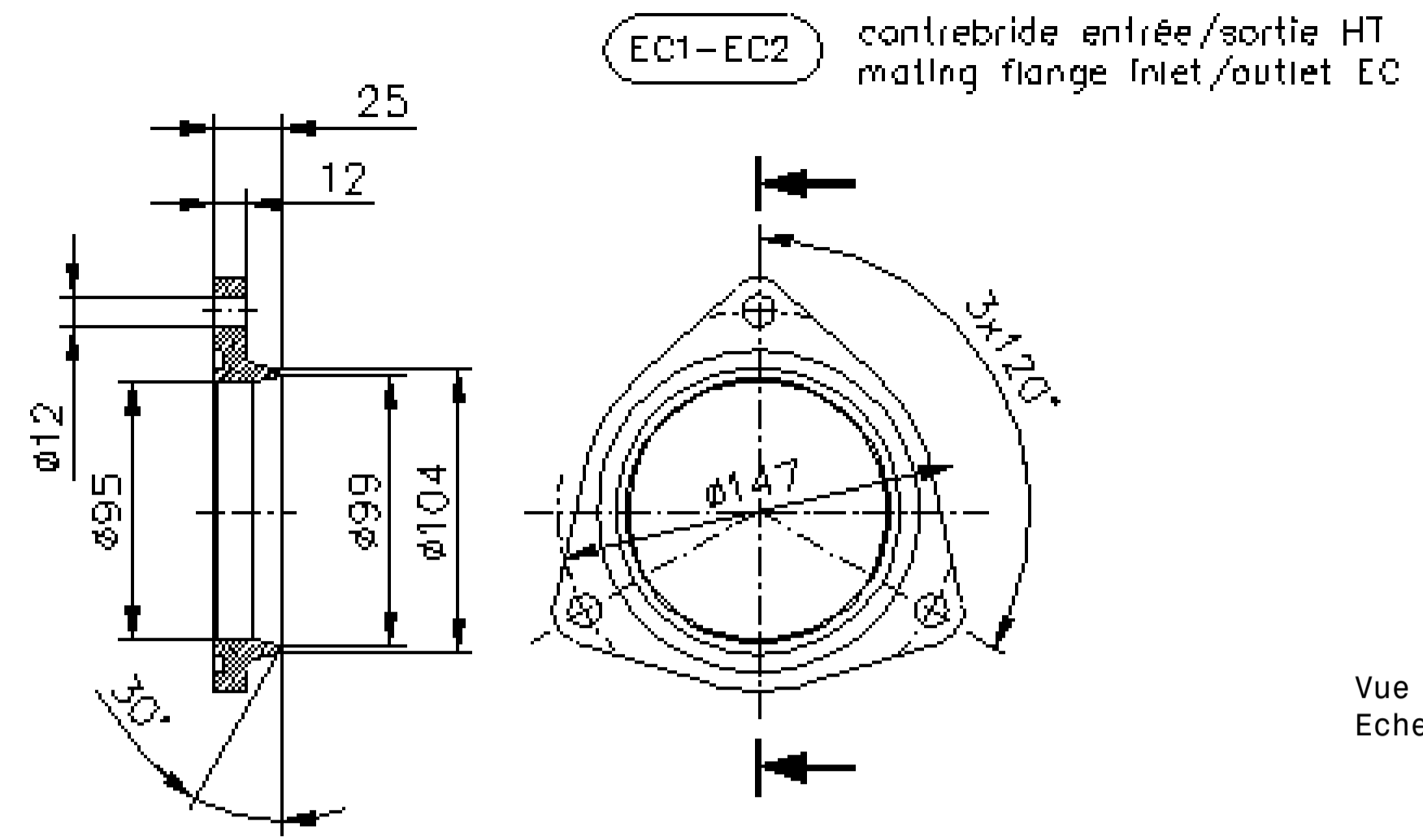
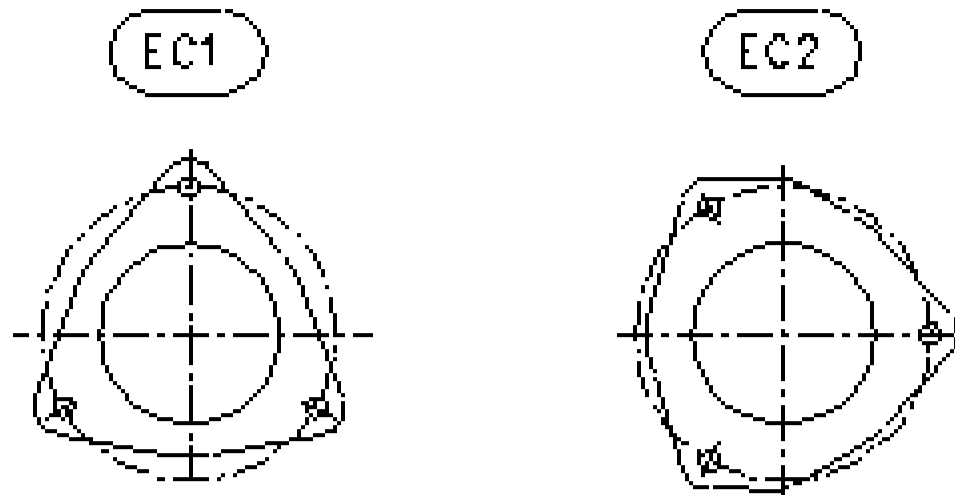

IC1-IC2 contrebride entrée/sortie BT
mating flange inlet/outlet IC

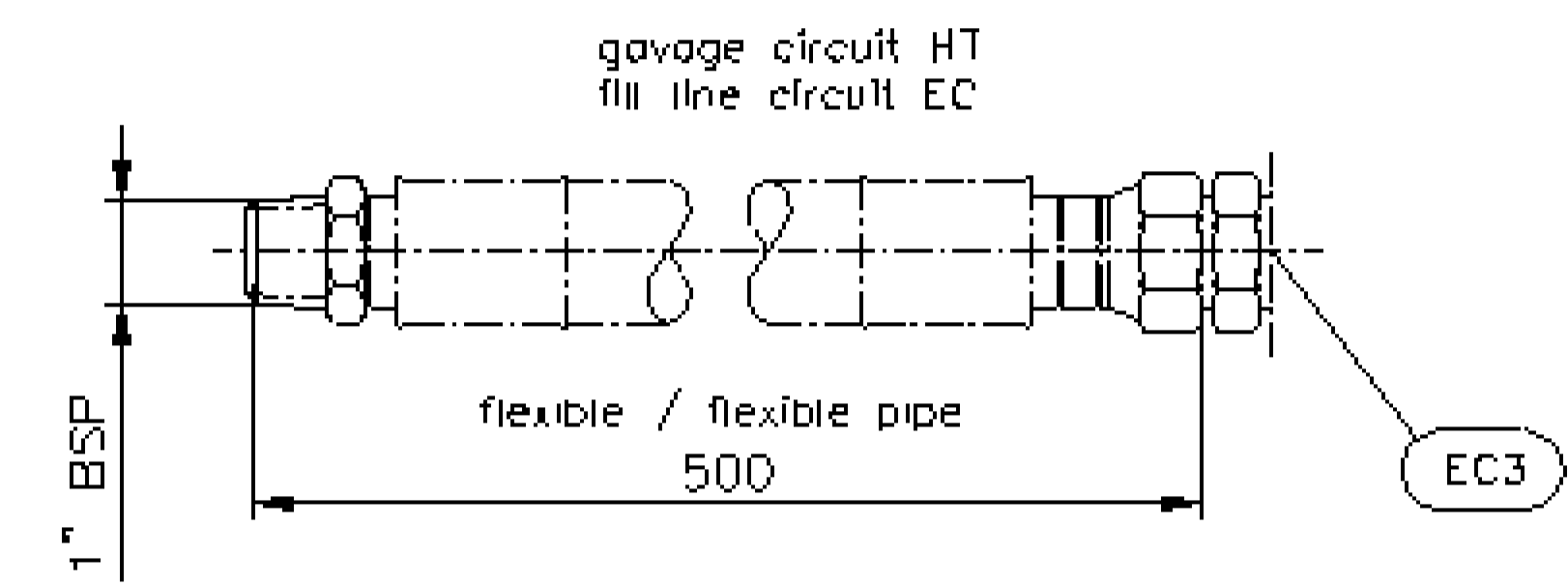
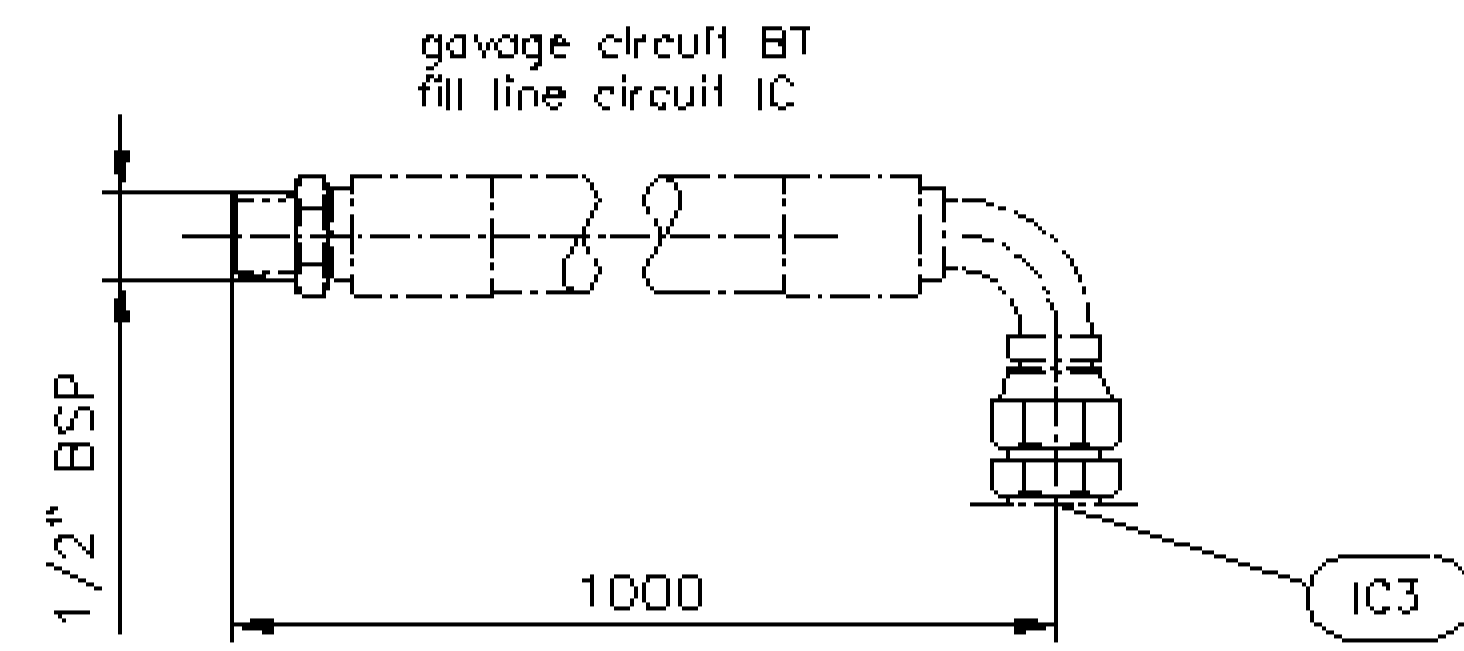
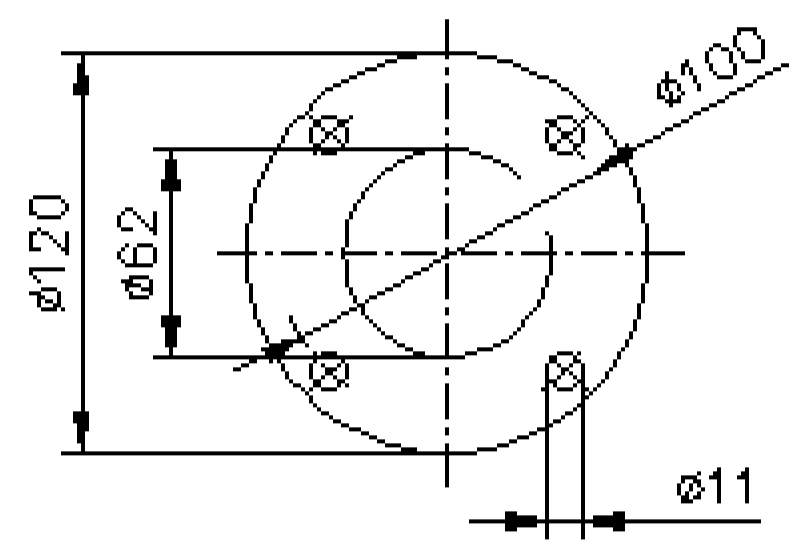

EX

bride tournante sur compensateur
perçage suivant DIN 86044

rotating flange on expansion bellows
drill according to DIN 86044

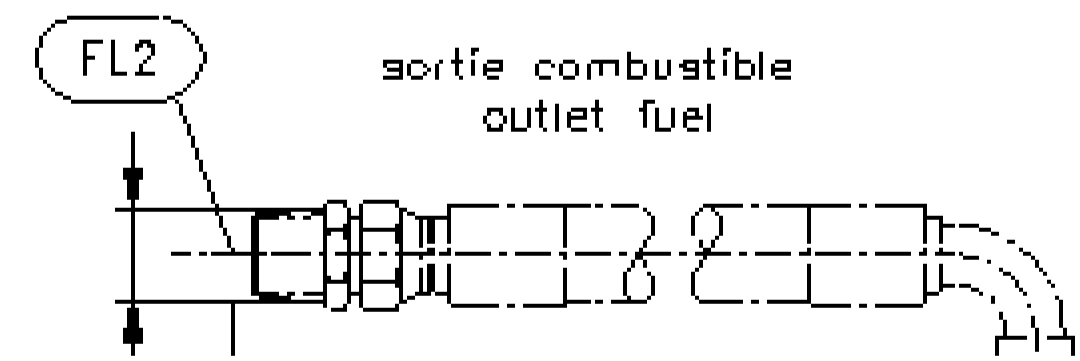
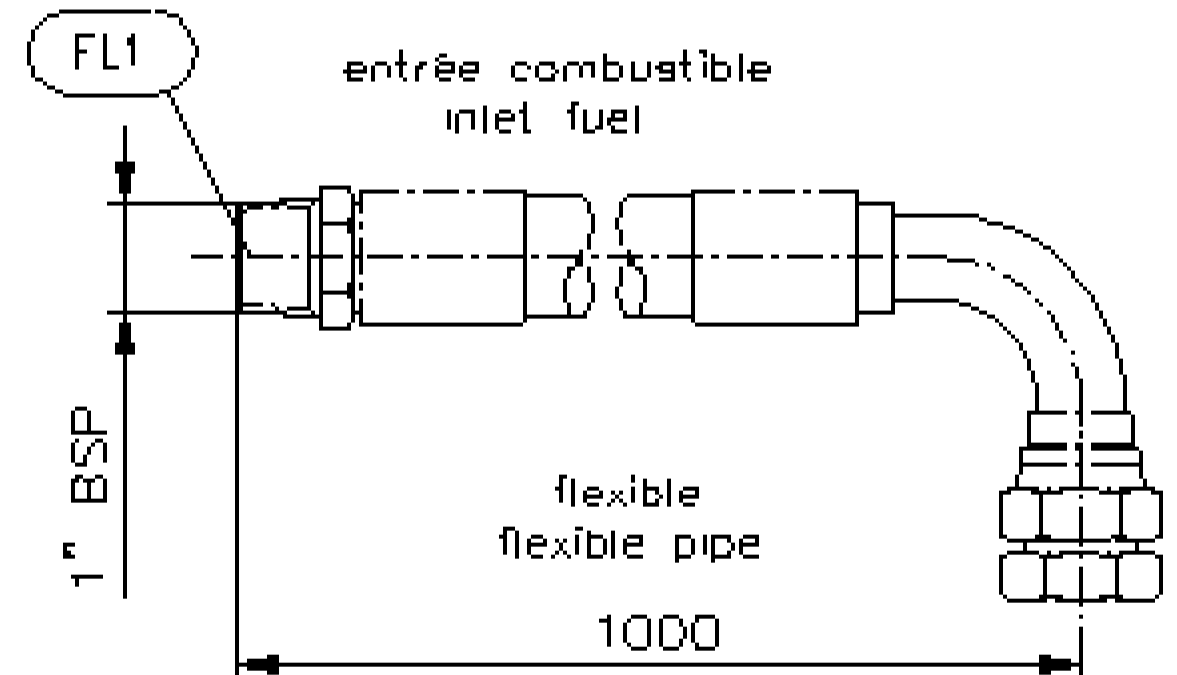
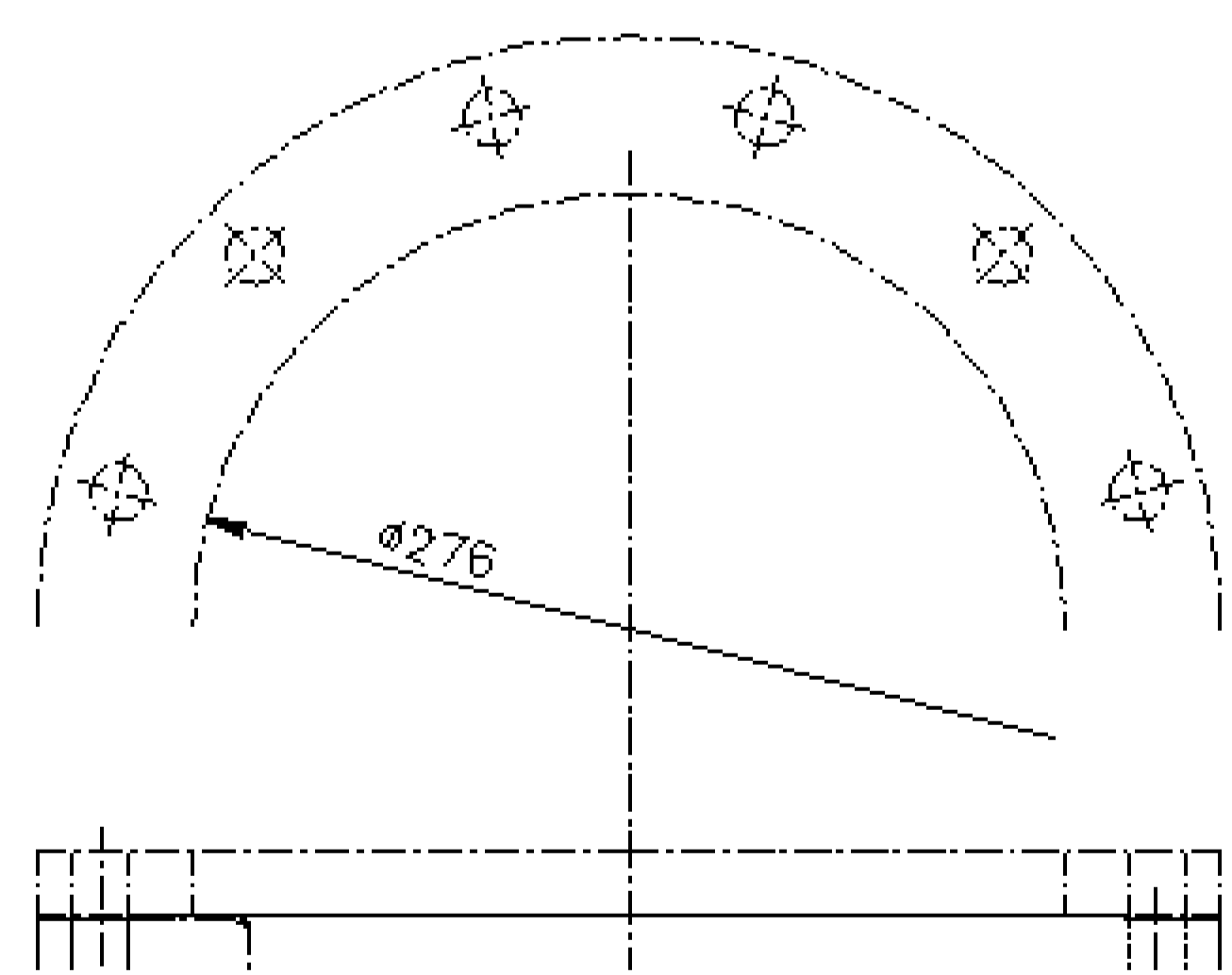

FOLIO 2/3
DETAILS RACCORDEMENT
(SHEET 2/3
CONNETING DETAILS)

Ce plan vous est remis à titre indicatif et peut être révisé sans préavis.
This drawing is for informational purposes only and maybe changed whitout notice.

| | | | | | |
|--------------------------|---|--------------------|-----------------------------------|--------------------------------------|------------------------------|
| F | MISE A JOUR COTE L1 | 27/10/14 | BERNARD R | | |
| E | AJOUT ALTERNATEUR LSA 512 VL95 | 21/08/14 | NICOT M | | |
| D | ALESAGE CONTRE BRIDE ECHAPPEMENT Dia246 DEVIENT Dia276 | 02/04/14 | KERDRAON C. | | |
| C | Mise à jour générale | 30/04/13 | G. ARCH | | |
| B | Modification tableau: Evolution type alternateur | 28/09/11 | G. ARCH | | |
| A | Création du document (First issue) | 05/04/11 | G. ARCH | | |
| Rev | Désignation de la modification (Description of change) | Statut (Status) | Date Dessiné par (Drawn by) | Visa Verificateur (Checked by) | Date Visa (Checked by) |
| Matière (Material) | - | | Format (Size) | A1 | |
| Revêtement (Coating) | - | | Echelle (Scale) | 1/4 | |
| Tolérance (Tolerance) | ISO 2768-mK | | Folio (Sheet) | 2/3 | |
| Désignation : (Title) | GRUPE ELECTROGENE / GENERATING SET (MOTEUR / ENGINE MTU 20V4000-G03) | | Masse (Weight) | Kg | |
| | 3-00-01-4478-01 | | Rev. : F | | |



12 bis rue de la Villeneuve CS82848 29472 BREST Cedex2 Tel: 02 98 41 41 41 Fax: 02 98 41 63 07
CE PLAN EST LA PROPRIETE DE SDMO. IL NE PEUT ETRE REPRODUIT, UTILISE OU COMMUNIQUE SANS SON AUTORISATION
THIS DRAWING IS UNDER PROPERTY OF THE COMPANY. IT CANNOT BE PRINTED, USED OR COMMUNICATED WITHOUT ITS AUTHORIZATION

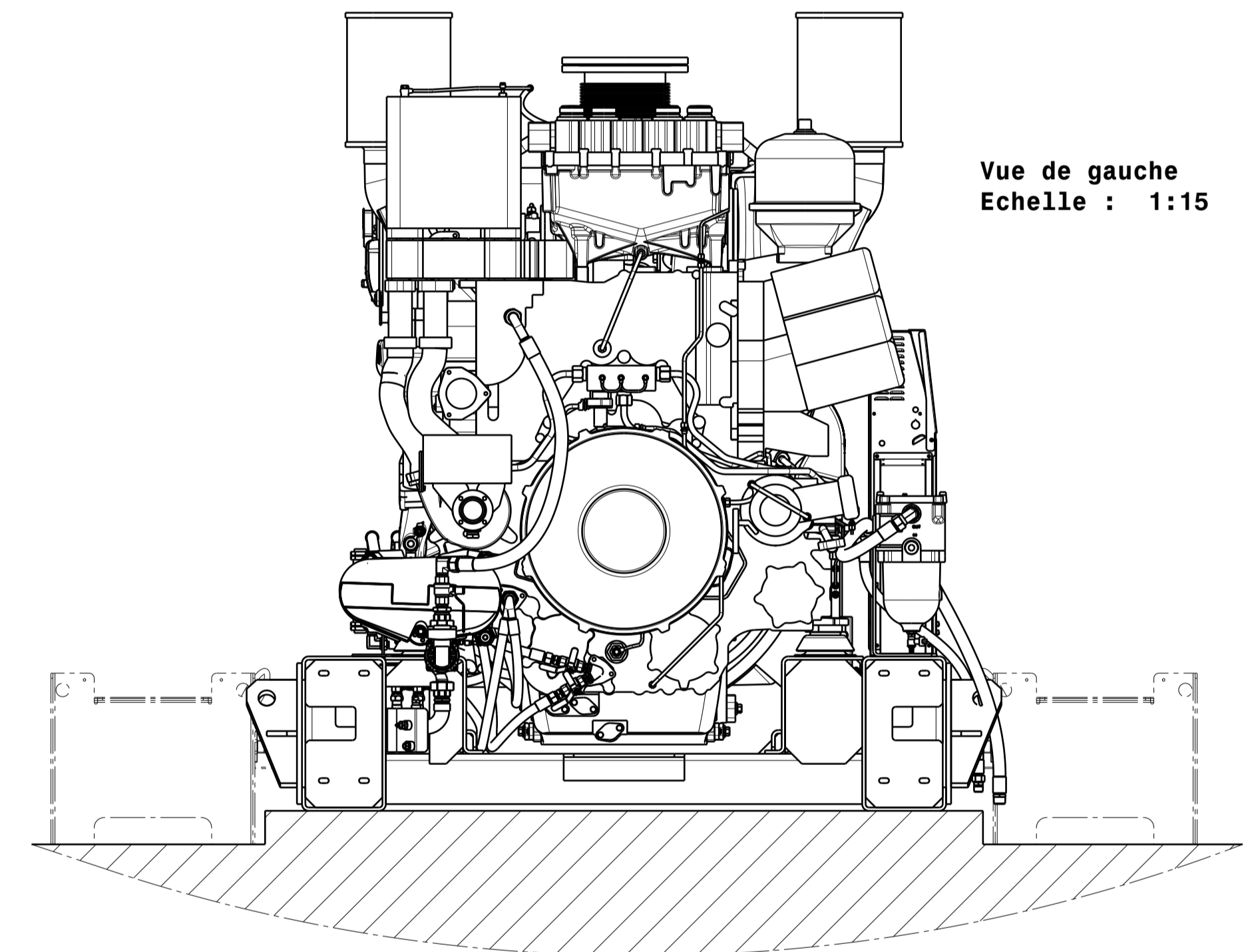
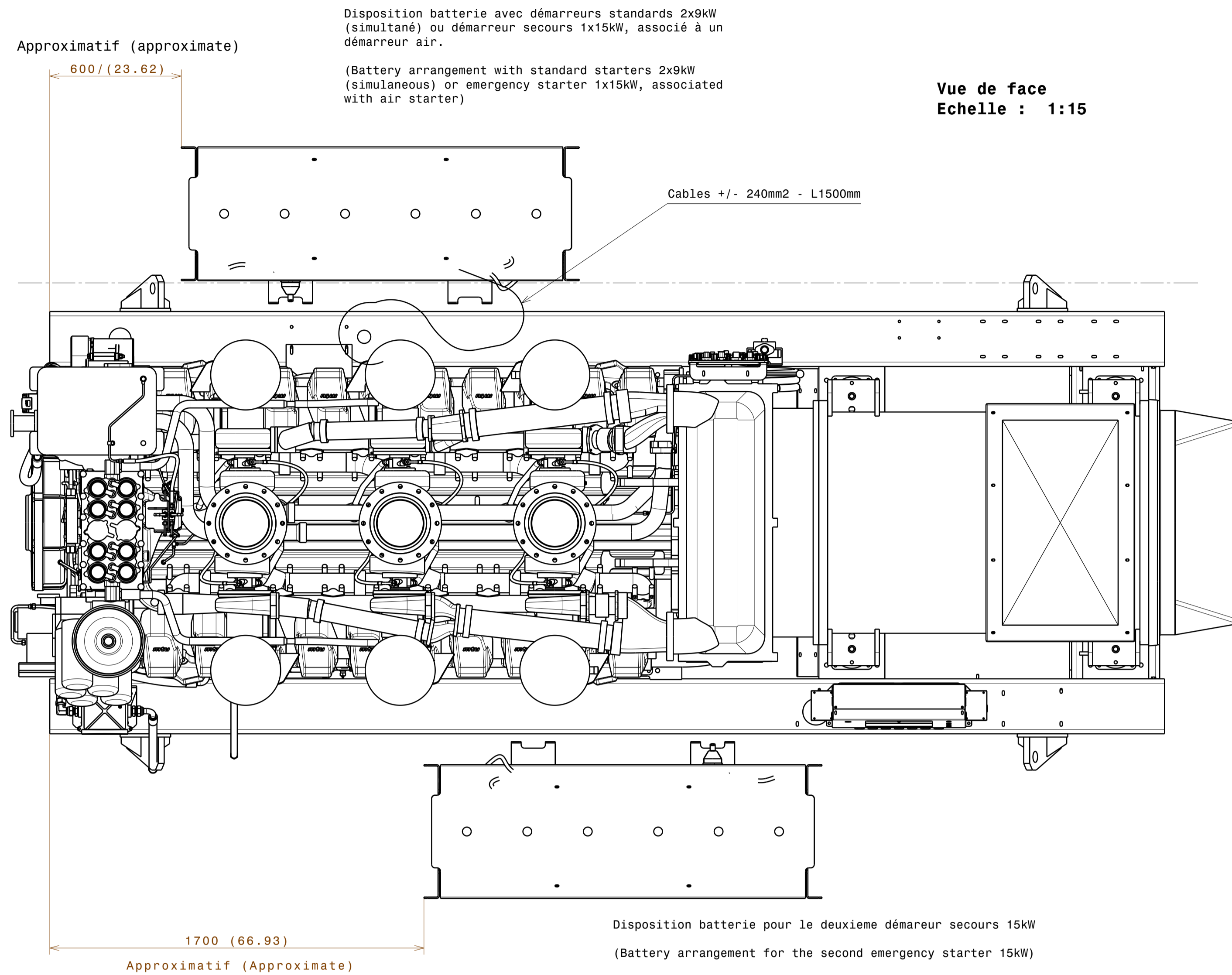

Vue de face
Echelle : 1:15

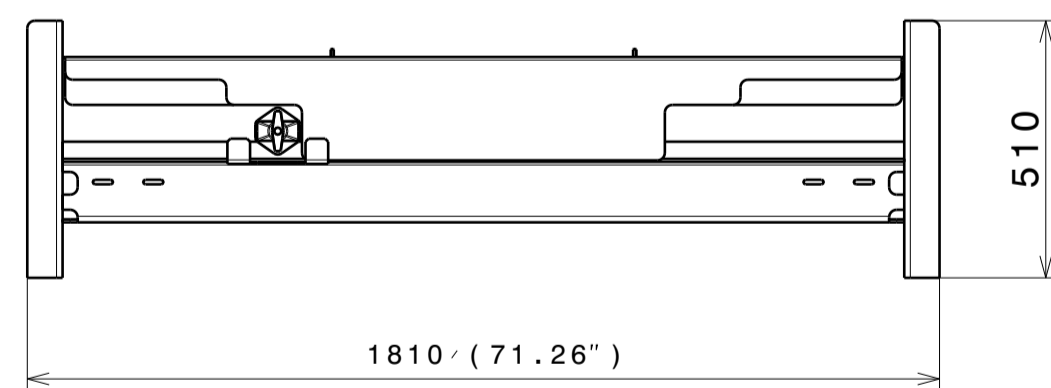

Vue de gauche
Echelle : 1:15

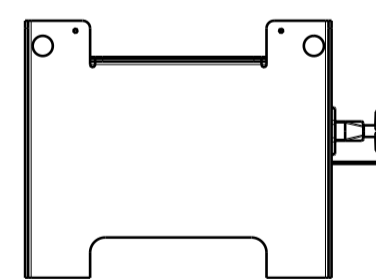

Vue de dessus
Echelle : 1:15

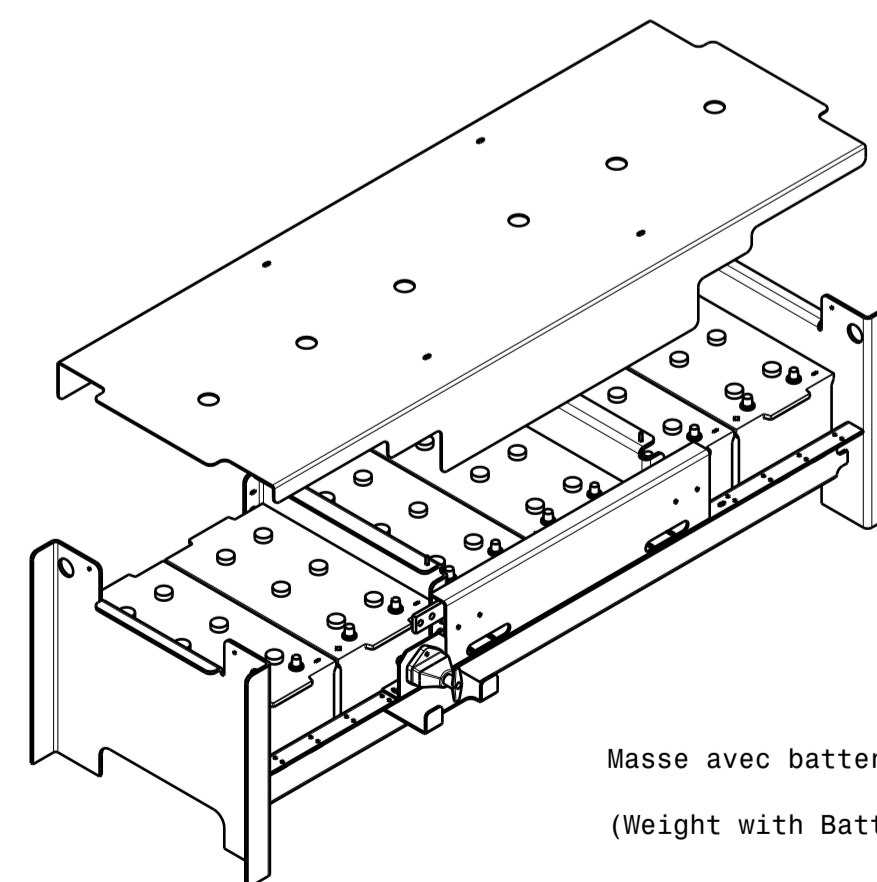
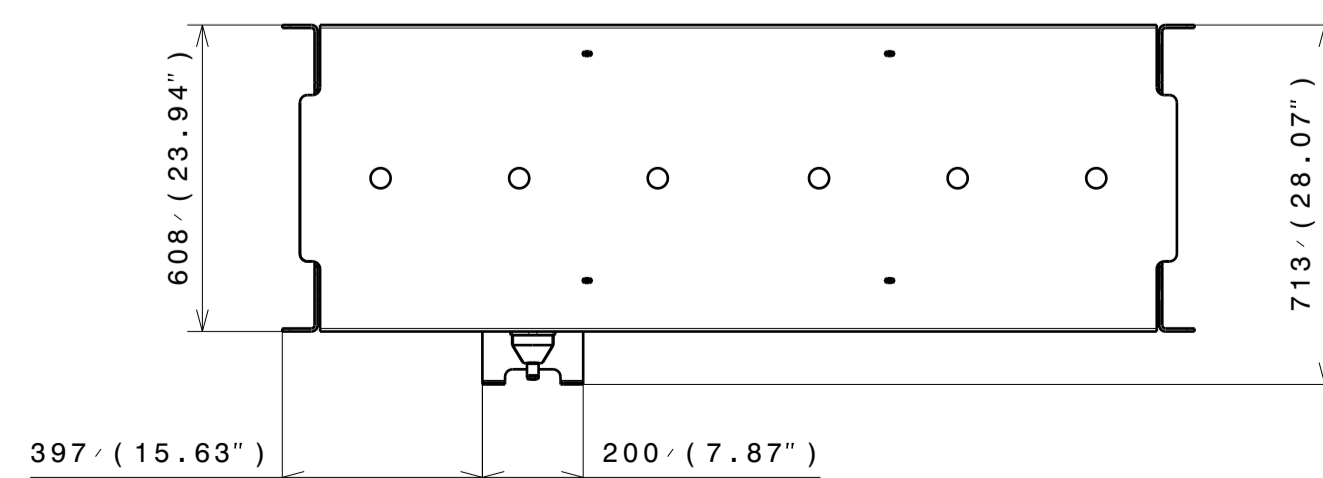

FOLIO 3/3
POSITIONNEMENT BATTERIE DE DEMARRAGE (OPTION)
(SHEET 3/3
START BATTERY ARRANGEMENT (OPTIONAL))

| F | MISE A JOUR COTE L1 | 27/10/14 | BERNARD R | | |
|-----------------------|---|--------------------|----------------|----------------------|----------------|
| E | AJOUT ALTERNATEUR LSA 512 VL95 | 21/08/14 | NICOT M | | |
| D | ALESAGE CONTRE BRIDE ECHAPPEMENT Dia246 DEVIENT Dia276 | 02/04/14 | KERDRAON C. | | |
| C | Mise à jour générale | 30/04/13 | G. ARCH | | |
| B | Modification tableau: Evolution type alternateur | 28/09/11 | G. ARCH | | |
| A | Création du document (First issue) | 05/04/11 | G. ARCH | | |
| Rev | Désignation de la modification (Description of change) | Statut (Status) | Date (Date) | Visa (Checked by) | Date (Date) |
| | | | | | |
| Matière (Material) | - | | | Format (Size) | A1 |
| Revêtement (Coating) | - | | | Echelle (Scale) | 1/15 |
| Tolérance (Tolerance) | ISO 2768-mK | | | Folio (Sheet) | 3/3 |
| Désignation (Title) | GRUPE ELECTROGENE / GENERATING SET (MOTEUR / ENGINE MTU 20V4000-G03) | | | Masse (Weight) | Kg |
| | 3-00-01-4478-01 | | | Rev.: F | |

Ce plan vous est remis à titre indicatif et peut être révisé sans préavis.
This drawing is for informational purposes only and maybe changed without notice.



12 bis rue de la Villeneuve CS02848 29472 BREST Cedex2 Tél. 02 98 41 41 41 Fax 02 98 41 63 07
CE PLAN EST LA PROPRIÉTÉ DE SDMO. IL NE PEUT ÊTRE REPRODUIT, UTILISÉ OU COMMUNIQUÉ SANS SON AUTORISATION
THIS DRAWING IS UNDER PROPERTY OF THE COMPANY. IT CANNOT BE PRINTED, USED OR COMMUNICATED WITHOUT ITS AUTHORIZATION