

FOR INDIVIDUAL GEN SET MODEL TYPES SEE BROADCAST LITERATURE

ENGINE TYPE: 6090HF485

USABLE FUEL CAPACITY: (INTEGRAL) 711 LITRES  
(BUNDED) 642 LITRES

WEIGHT (DRY): 2671 Kgs

WEIGHT (WET): 3337 Kgs

OIL CAPACITY: 32L

COOLANT CAPACITY: 29L

GENERATOR IS TO BE PLACED ON A FLAT FLOOR OR CONCRETE BASE

Model Ref	Engine	Alternator	Weight Dry	Weight Wet
BCJD 250-60 T3	6090HF485	UCDI 274 K	2451Kg	3117Kg
BCJD 275-60 T3	6090HF485	HCI 444 D	2671Kg	3337Kg

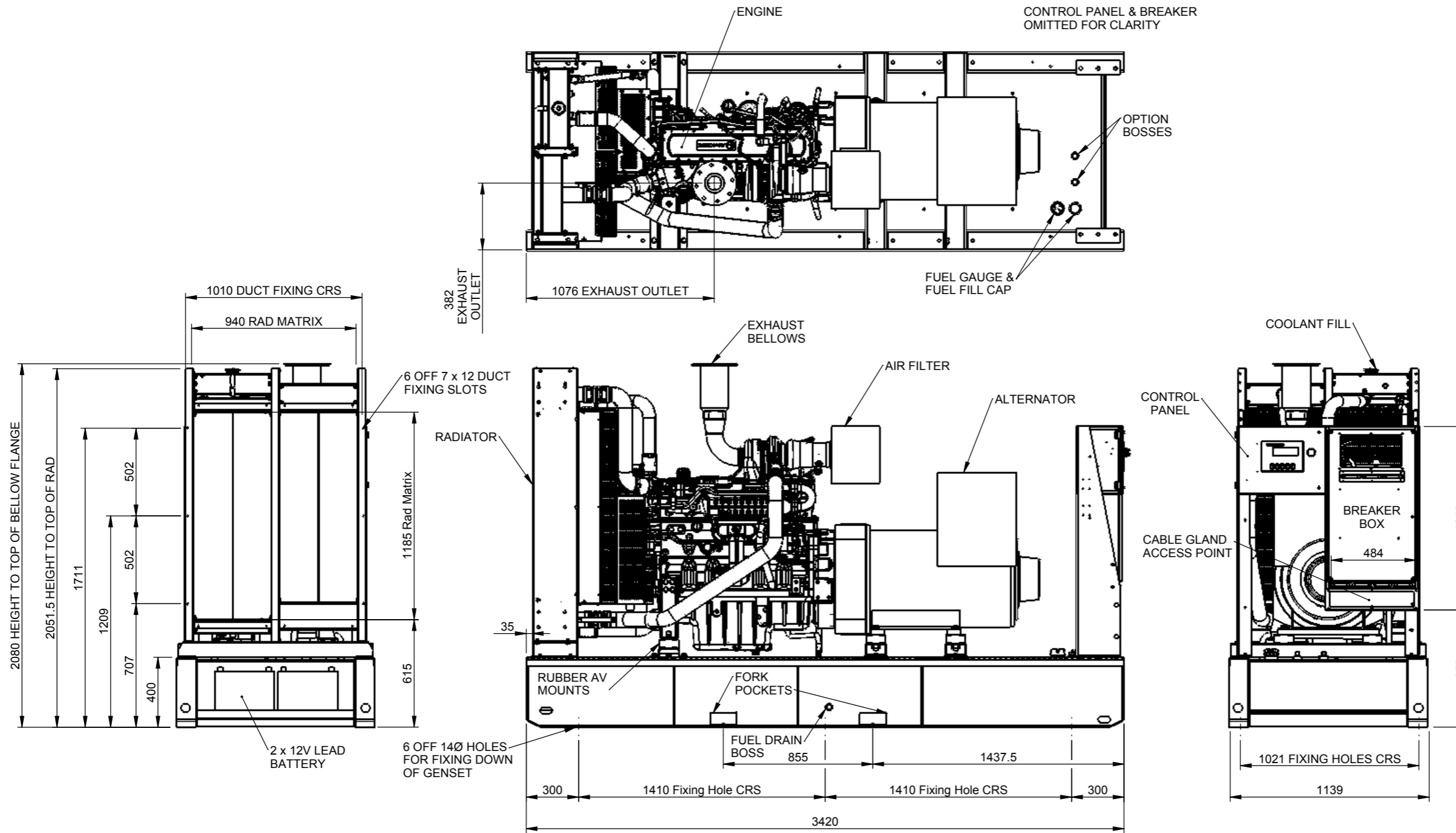

B	Redrawn with New Logo, Tech Data Added	SJB	4/6/10
C	Table Added. Tech Info Corrected	SJB	17/11/11
D	REVISED TO REFLECT OF6 EXTENSION	IWR	23/04/12

REV	DETAILS	APP'D	DATE
-----	---------	-------	------

NOTES - MECHANICAL  
TOLERANCES:  
GENERAL TOLERANCES: +/- 5mm  
FABRICATION: +/- 3mm  
HOLE CENTRES: +/- 1mm  
OTHER TOLERANCES AS OTHERWISE STATED WHERE REQUIRED  
GEOMETRICAL AND OTHER TOLERANCES AS STATED.  
THIRD ANGLE PROJECTION

DESCRIPTION  
JD6090HF485 Open Frame 6 Sales GA

SHEET 1 of 1	
CREATED BY:	P RUTTER
DATE:	
MODIFIED BY:	I RUTTER
DATE:	23/04/12
CHECKED BY:	D MADDISON
DATE:	17/11/11
ISSUE:	D

DRAWING No:  
**JGA050**

**broadcrown**  
Broadcrown Limited (Group Headquarters)  
Airfield Industrial Estate, Hixon, Stafford,  
ST18 0PF, United Kingdom.  
tel: +44 (0) 1889 272200  
www.broadcrown.com

MATERIAL:	
FINISH:	