

A
B
C
D
E
F
G
H

BC Ref	Engine	Alternator	Oil Capacity (L)	Coolant Capacity (L)	Dry Weight (kg)	Wet Weight (Kg)
BCJD 200-60 T3	6068 HF485	UCI274 H	32	32	2405	2913
BCJD 250-60 T3	6068 HF485	UCDI274 K	32	32	2500	2590

Model Illustrated - BCJD250-60 T3
 For Individual Gen Set Model Types See Broadcrown Literature
 Useable Fuel Capacity: Integral - 575L / Bunded - 525L
 Generator Is To Be Placed On A Flat Floor Or Concrete Base

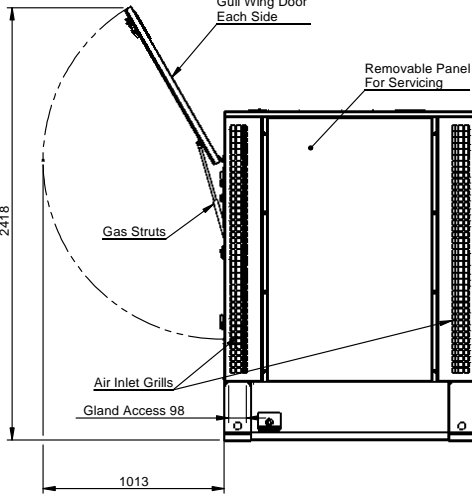
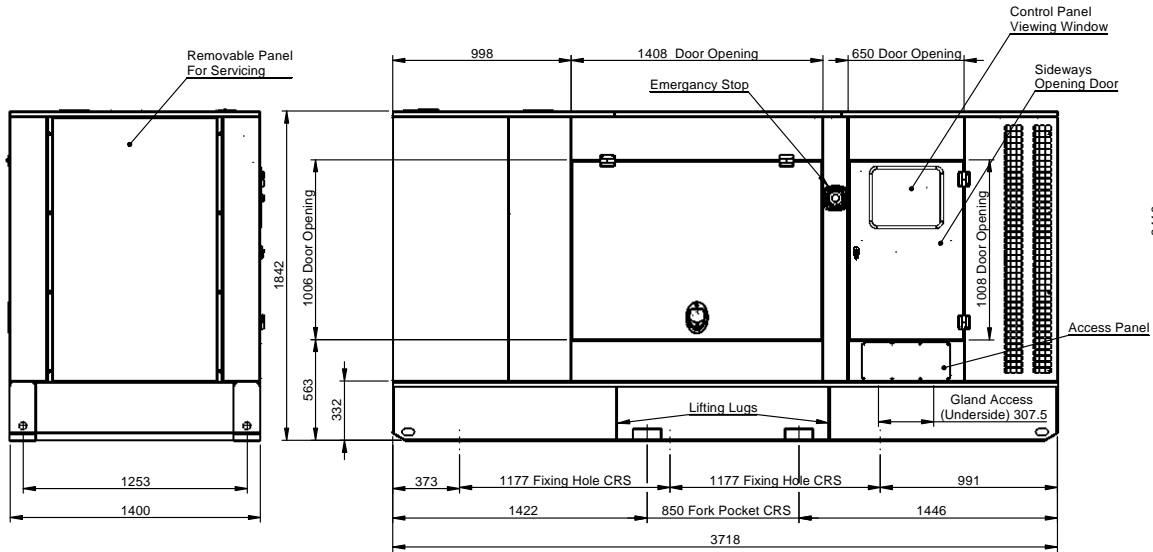
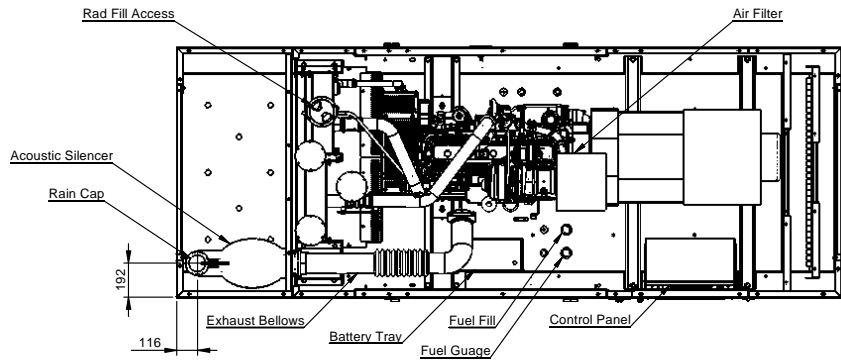

REV	DETAILS	APPD	DATE

NOTES - MECHANICAL
 TOLERANCES:
 GENERAL TOLERANCES: +/- 5mm
 FABRICATION: +/- 3mm
 HOLE CENTRES: +/- 1mm
 OTHER TOLERANCES AS OTHERWISE STATED WHERE REQUIRED
 GEOMETRICAL AND OTHER TOLERANCES AS STATED.

THIRD ANGLE PROJECTION

DESCRIPTION
 Canopy 4R John Deere 60Hz Sales GA
 SHEET 1 of 1
 CREATED BY: L.Richards
 DATE: 23.04.2012
 MODIFIED BY:
 DATE:
 CHECKED BY: S.Bean
 DATE: 14.05.2012
 ISSUE: A

DRAWING No:
JGA114

 Broadcrown Limited (Group Headquarters)
 Airfield Industrial Estate, Hixon, Stafford,
 ST18 0PF, United Kingdom.
 tel: +44 (0) 1889 272200
www.broadcrown.com

MATERIAL:	
FINISH:	