

ENGINE	ALTERNATOR	OIL CAPACITY	COOLING CAPACITY	WEIGHT (DRY)	WEIGHT (WET)
4045HF285	UCI 224 D	12L	13L	1386Kg	1578 Kg
4045HF285	UCI 274 C	12L	13L	1403 Kg	1595 Kg

FOR INDIVIDUAL GEN SET MODEL TYPES & ENGINE DATA SHEETS SEE
WWW.BROADCROWN.COM

GENERATOR TO BE PLACED ON A FLAT FLOOR OR CONCRETE BASE

USEABLE TANK CAPACITY = 223L INTEGRAL / 201L BUNDED

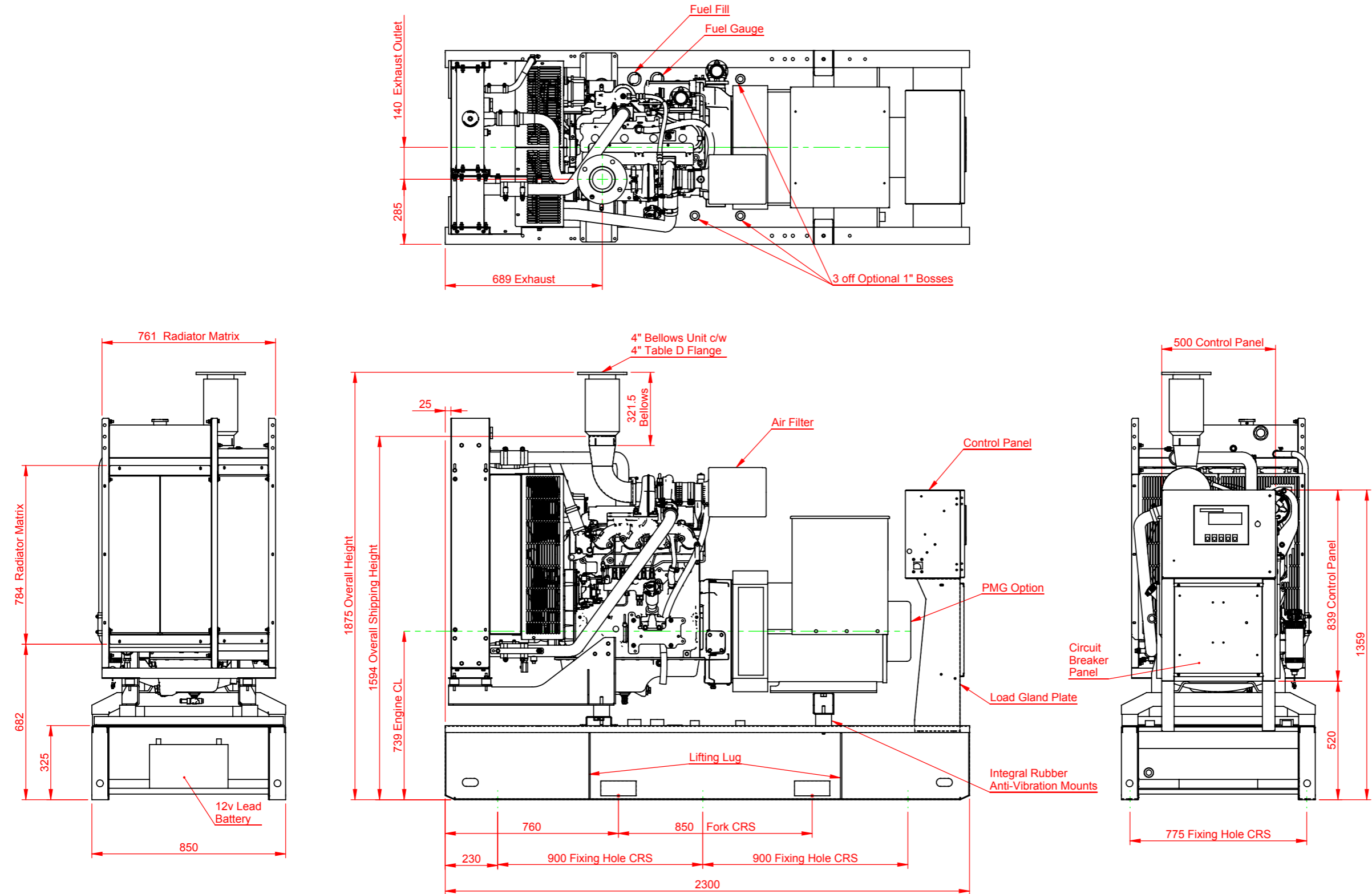

REV	DETAILS	APP'D	DATE
B	Exhaust Outlet Detail & Position Changed Cable Entry Detail Added	PR	5/10/7
C	Redrawn	SJB	2/6/10
D	Tank Capacities Corrected	SJB	28/7/11
E	Added Dimensions & Information Changed	LR	30/11/11

REV	DETAILS	APP'D	DATE
-----	---------	-------	------

NOTES - MECHANICAL
TOLERANCES:
GENERAL TOLERANCES: +/- 5mm
FABRICATION: +/- 3mm
HOLE CENTRES: +/- 1mm
OTHER TOLERANCES AS OTHERWISE STATED WHERE REQUIRED
GEOMETRICAL AND OTHER TOLERANCES AS STATED.

THIRD ANGLE PROJECTION

DESCRIPTION
Open Frame 3 - 4045HF285 Sales GA

SHEET 1 of 1

CREATED BY:	P RUTTER
DATE:	
MODIFIED BY:	L.Richards
DATE:	28.11.2011
CHECKED BY:	P RUTTER
DATE:	28.7.11
ISSUE:	E

DRAWING No:
JGA031

broadcrown
Broadcrown Limited (Group Headquarters)
Airfield Industrial Estate, Hixon, Stafford,
ST18 0PF, United Kingdom.
tel: +44 (0) 1889 272200
www.broadcrown.com

MATERIAL:	
FINISH:	